



# EMPOWERING THE NEXT GENERATION OF NURSING LEADERS

Loyola University Maryland's Bachelor of Science in Nursing (BSN) program will prepare you for a dynamic career in nursing from the moment you step on campus. Distinguished by direct entry, our program ensures that you dive into nursing-specific didactic courses in your first year, setting us apart from programs that start during junior year. Clinical rotations begin in your sophomore year, providing early and extensive hands-on experience with nearly 900 hours of clinical practice—significantly more than many other BSN programs.

Our program is designed to integrate a holistic nursing education with an exceptional liberal arts foundation. Steeped in the Jesuit tradition, our BSN emphasizes academic excellence, personal formation, and a commitment to serving others. You will embark on a nursing journey that is as compassionate as it is comprehensive.



**LEARN MORE  
AND APPLY**

## PROGRAM HIGHLIGHTS

### INNOVATIVE CURRICULUM

Loyola's BSN program offers a rigorous curriculum that balances core nursing competencies with evidence-based nursing practices and our comprehensive liberal arts education. Students will engage in diverse clinical learning opportunities, utilizing state-of-the-art science laboratories and simulation labs to prepare for real-world nursing challenges.

### CLINICAL TRAINING

Clinical training is conducted through our partnership with Mercy Medical Center, a hospital recognized nationally for nursing excellence with an American Nurses Credentialing Center (ANCC) Magnet designation. This partnership provides students with hands-on experience in a variety of health care settings, ensuring they are well-prepared for their future roles as registered nurses.

### DEDICATED EXPERT FACULTY

With a 12:1 student-to-faculty ratio, our program offers personalized mentorship and guidance from experienced, interdisciplinary faculty members. Our teacher-scholars and clinical leaders are experts in their fields, dedicated to fostering a supportive learning environment that emphasizes both theoretical knowledge and practical skills.

### VALUES-BASED EDUCATION

Loyola's BSN program emphasizes the Jesuit values of social justice and ethical responsibility. These principles are integrated throughout the curriculum, ensuring our graduates are not only skilled professionals but also compassionate caregivers and principled leaders.



## THE LOYOLA DIFFERENCE

### A CLEAR PATH TO A NURSING CAREER

Successful applicants to Loyola's BSN degree program are accepted directly to the program, a distinction from many other undergraduate nursing programs. Your nursing-specific courses begin with a professional development seminar during the first week you arrive on campus. You will build confidence in your nursing competencies over all four years of your college experience. Loyola's rigorous education is grounded in the natural sciences and liberal arts, nursing theory, and nursing clinicals. One-on-one academic advising and support will prepare you for success with the National Council Licensure Examination (NCLEX). You will amplify your clinical judgment and compassionate delivery of care through goal setting, observation, practice, feedback, self-evaluation, and reflection.

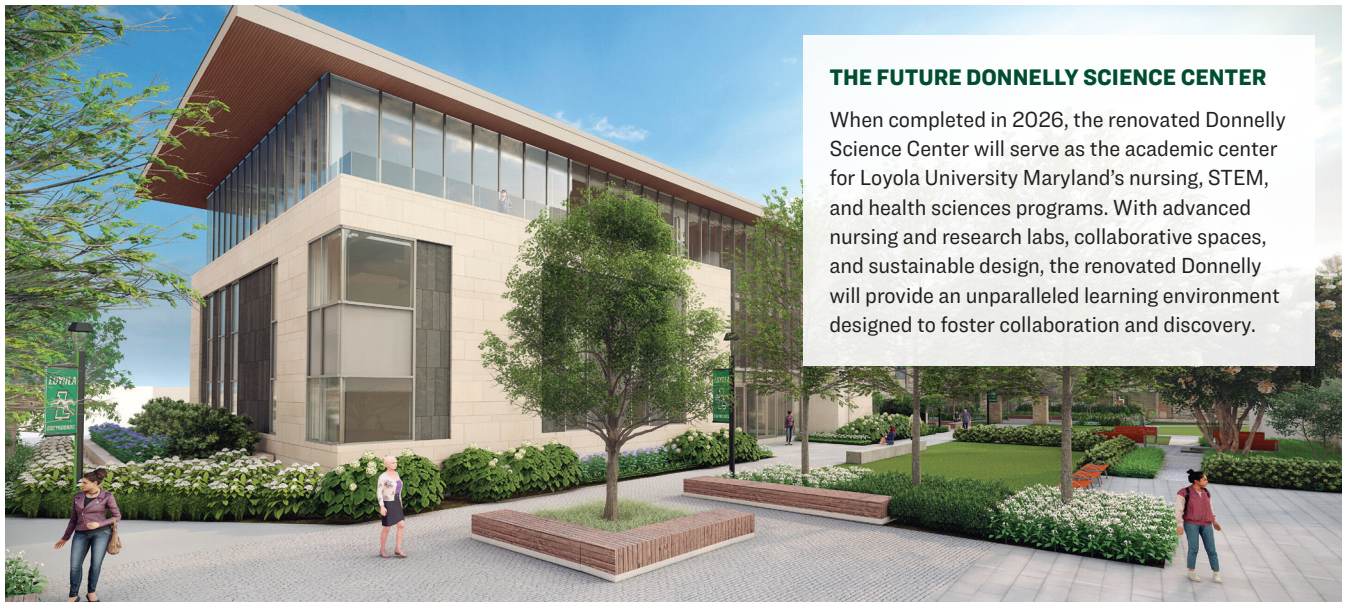

### THE FUTURE DONNELLY SCIENCE CENTER

When completed in 2026, the renovated Donnelly Science Center will serve as the academic center for Loyola University Maryland's nursing, STEM, and health sciences programs. With advanced nursing and research labs, collaborative spaces, and sustainable design, the renovated Donnelly will provide an unparalleled learning environment designed to foster collaboration and discovery.

## CLINICAL PARTNERSHIP WITH MERCY MEDICAL CENTER

Your education in direct patient care includes a wide range of clinical rotations at Mercy Medical Center, our nursing education partner. Mercy is recognized for its nursing excellence with an American Nurses Credentialing Center (ANCC) Magnet designation—a distinction held by fewer than 10% of U.S. hospitals. This makes Mercy Medical Center an inspiring environment for you to learn from experienced clinical nurse educators and interact with patients.

Mercy will become a familiar and comforting environment as you advance through your nursing clinical placements. Each of your nine clinical placements will lead you to practice and reflect on a critically important aspect of nursing, which involves caring for patients of all ages and in a wide variety of settings. Mercy Medical Center and Loyola University Maryland share a deep commitment to Baltimore, a city that has been the home of these two Catholic institutions for more than 150 years. Your clinicals will incorporate ethical and social justice perspectives that you have explored in the classroom.

## SAMPLE COURSES & CLINICALS

- Nursing Professional Development in Clinical Judgment
- Life Span Development
- Bioethics
- Human Nutrition
- Human Anatomy and Physiology + Laboratory
- Mental Health Promotion and Psychiatric Nursing + Clinical
- Fundamentals of Nursing + Clinical
- Pathophysiology
- Pharmacology Clinical Laboratory
- Nursing Care of Adults and Older Adults + Clinical
- Maternal Health and Childbearing + Clinical
- Transition into Professional Nursing Clinical
- Leadership and Management in Nursing + Clinical

## APPLYING TO THE NURSING PROGRAM

### APPLY BY NOVEMBER 15

Admission to Loyola's BSN program is limited to first-year applicants who are directly accepted into this specific program. Given the limited number of seats available for the nursing program compared to the overall class, admission to the nursing program is significantly more competitive. We strongly encourage students interested in our BSN program to apply by November 15 under our Early Decision I or Early Action decision plan. While we do accept Nursing applications during the Regular Decision round, admission will be contingent on space availability.

Admission into Loyola University Maryland's Nursing (BSN) program is highly selective, reflecting the program's pre-licensure status and the limited number of spaces available. We employ a holistic review process, but given the program's specifics, applicants are subjected to an additional, detailed assessment.



**LEARN MORE ABOUT  
OUR APPLICATION AND  
ADMISSION REVIEW PROCESS**

### QUESTIONS? CONTACT US.

**Questions about the  
nursing program:**  
nursing@loyola.edu

**Questions about admission  
to the nursing program:**  
admission@loyola.edu

Loyola University Maryland's Bachelor of Science in Nursing (BSN) program has been approved by the Maryland Higher Education Commission (MHEC) and the Maryland Board of Nursing (MBON). We are preparing to welcome our first BSN cohort in Fall 2025. Statements and disclosures can be found on our website: [loyola.edu/nursing](https://loyola.edu/nursing).